

**FLASHING LAP NOTE**

LAP APRON, COPING AND CLEATS 2" MINIMUM WITH 2 ROWS OF BUTYL SEALANT.

**FASTENER NOTE**

ALL EXTERIOR FASTENERS ARE TO BE EITHER STAINLESS OR PLATED CARBON STEEL.

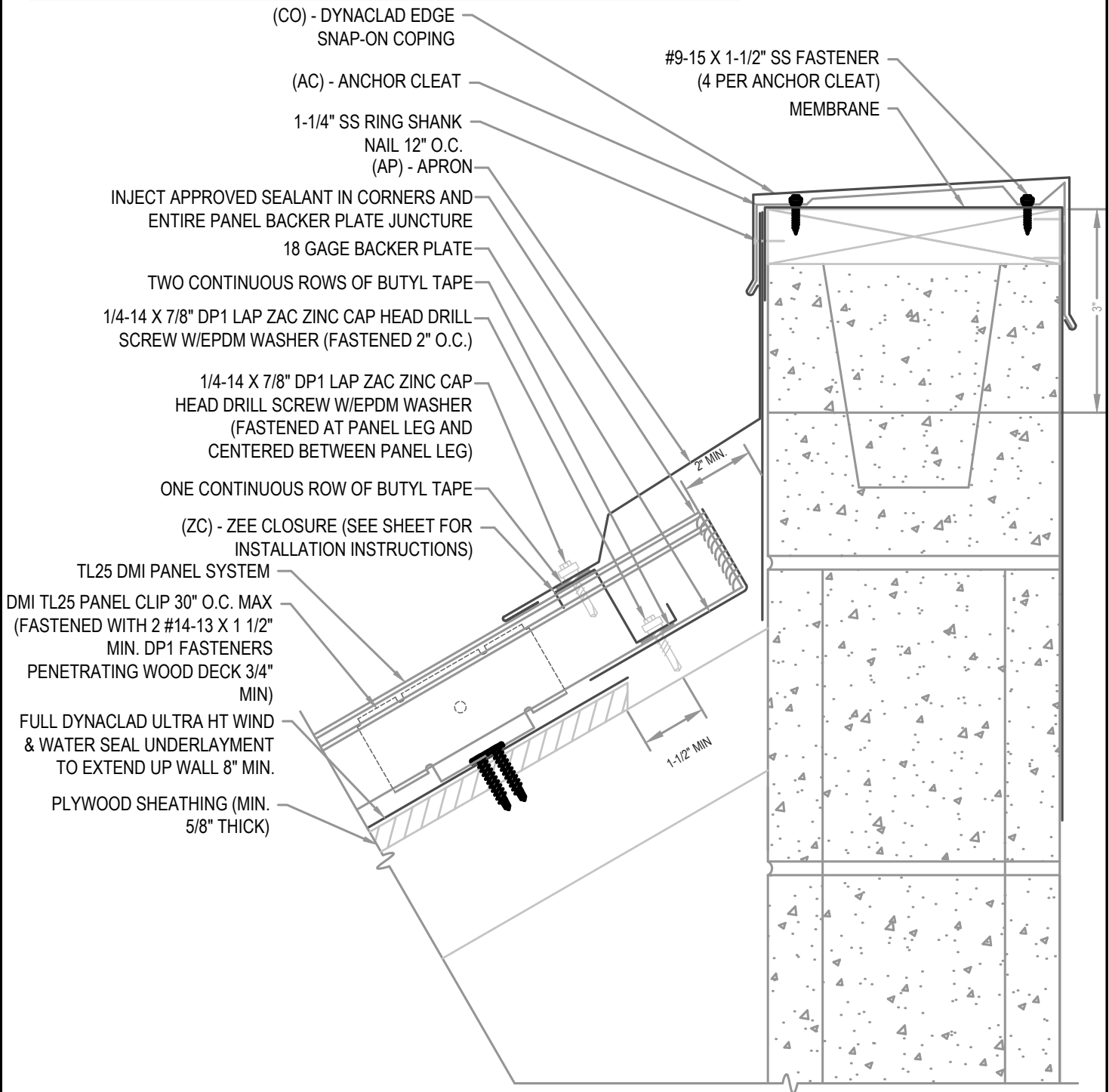

TL25 DMI PANEL SYSTEM  
 DMI TL25 PANEL CLIP 30" O.C. MAX  
 (FASTENED WITH 2 #14-13 X 1 1/2"  
 MIN. DP1 FASTENERS  
 PENETRATING WOOD DECK 3/4"  
 MIN)  
 FULL DYNACLAD ULTRA HT WIND  
 & WATER SEAL UNDERLAYMENT  
 TO EXTEND UP WALL 8" MIN.  
 PLYWOOD SHEATHING (MIN.  
 5/8" THICK)



**HYDROSTATIC APRON W/ COPING**

● **PROVEN** ● **DEPENDABLE** ● **SUSTAINABLE** ●

**METAL ENVELOPE SYSTEMS SINCE 1988**

WWW.DMIMETALS.COM

Detail:  
**TL25 06-04-WH**

Issue/Rev Date: **01/17** Scale: **3"=1'-0"**