

**FLASHING LAP NOTE**

LAP (RW) - RAKE WALL AND RAT GUARD (SLOPED) 2" MINIMUM WITH 2 ROWS OF BUTYL SEALANT.

**FASTENING NOTE**

MAXIMUM PANEL ATTACHMENT FASTENERS 24" O.C.  
FASTENERS TO PENETRATE WOOD 3/4" MIN AND METAL FRAMING 1/2" MIN.

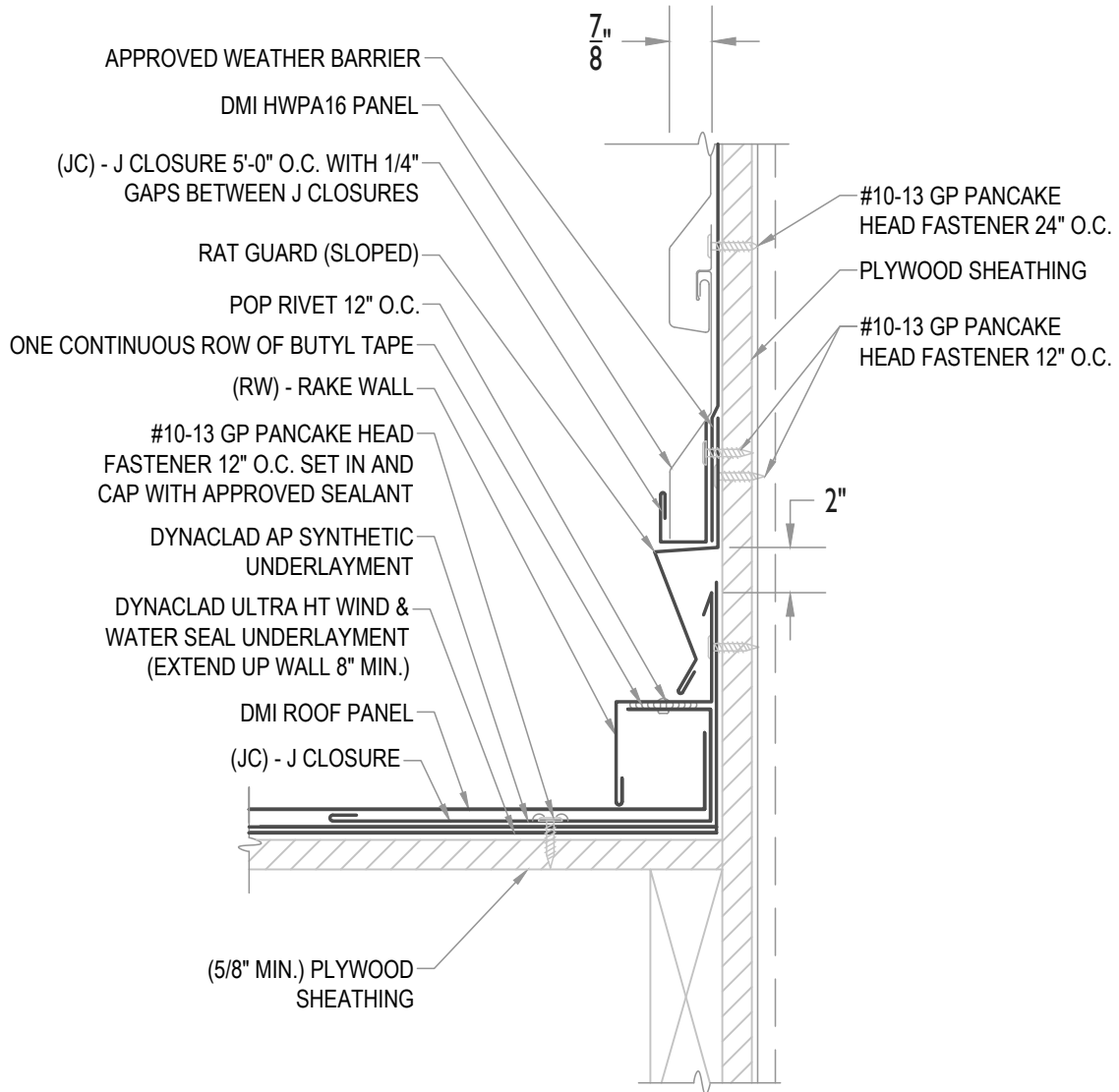

**RAKE WALL**

• **PROVEN** • **DEPENDABLE** • **SUSTAINABLE** •

**METAL ENVELOPE SYSTEMS SINCE 1988**

WWW.DMIMETALS.COM

Detail:

**HHPA16-H-05-00**

Issue/Rev Date:

**04/19**

Scale:

**3"=1'-0"**