

FLASHING LAP NOTE

LAP APRON, COPING AND CLEATS 2" MINIMUM WITH 2 ROWS OF BUTYL SEALANT.

FASTENER NOTE

ALL EXTERIOR FASTENERS ARE TO BE EITHER STAINLESS OR PLATED CARBON STEEL.

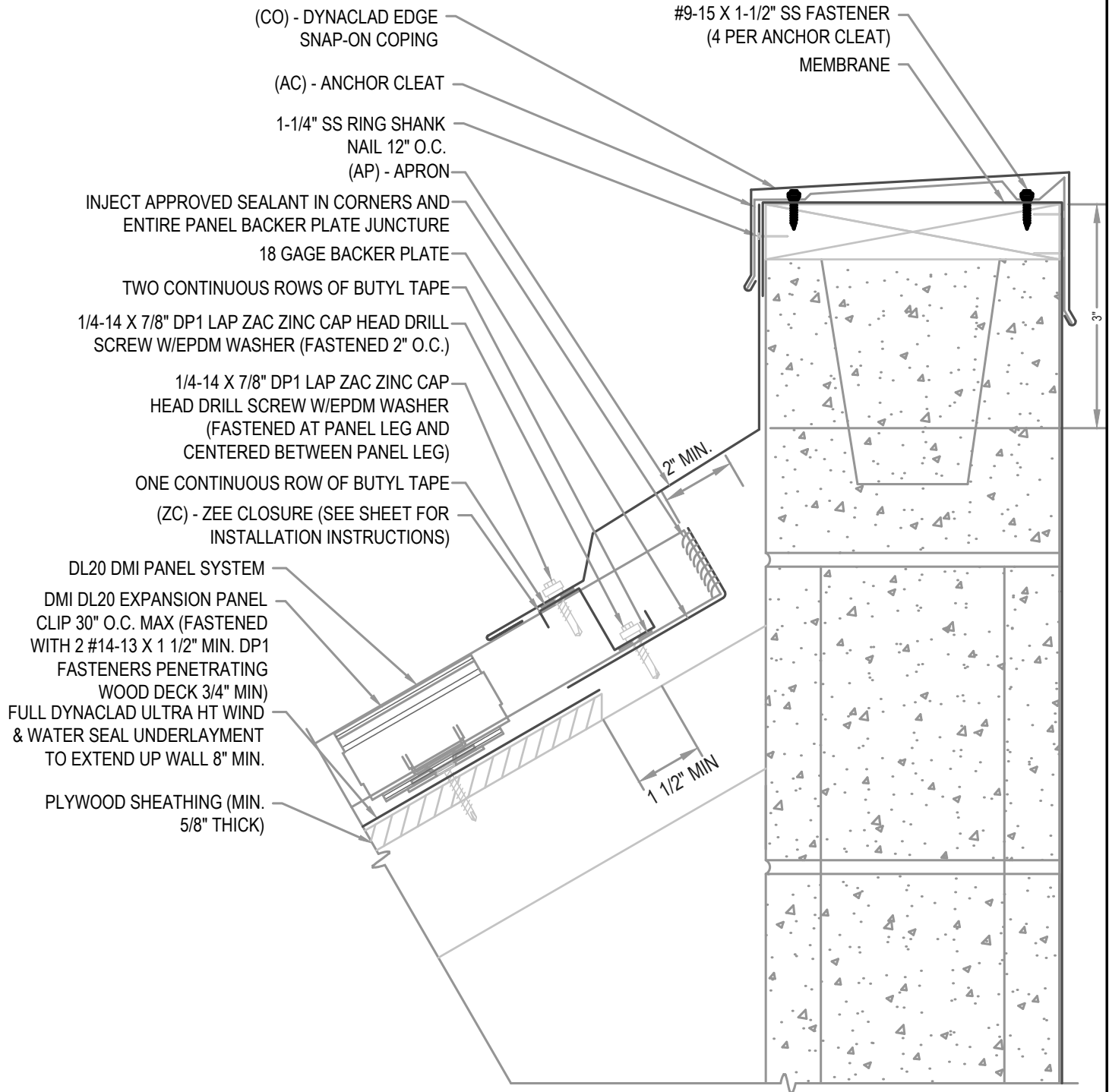

(CO) - DYNACLAD EDGE
SNAP-ON COPING

#9-15 X 1-1/2" SS FASTENER
(4 PER ANCHOR CLEAT)

(AC) - ANCHOR CLEAT

MEMBRANE

1-1/4" SS RING SHANK
NAIL 12" O.C.

(AP) - APRON

INJECT APPROVED SEALANT IN CORNERS AND
ENTIRE PANEL BACKER PLATE JUNCTURE

18 GAGE BACKER PLATE

TWO CONTINUOUS ROWS OF BUTYL TAPE

1/4-14 X 7/8" DP1 LAP ZAC ZINC CAP HEAD DRILL
SCREW W/EPDM WASHER (FASTENED 2" O.C.)

1/4-14 X 7/8" DP1 LAP ZAC ZINC CAP
HEAD DRILL SCREW W/EPDM WASHER
(FASTENED AT PANEL LEG AND
CENTERED BETWEEN PANEL LEG)

ONE CONTINUOUS ROW OF BUTYL TAPE

(ZC) - ZEE CLOSURE (SEE SHEET FOR
INSTALLATION INSTRUCTIONS)

DL20 DMI PANEL SYSTEM

DMI DL20 EXPANSION PANEL
CLIP 30" O.C. MAX (FASTENED
WITH 2 #14-13 X 1 1/2" MIN. DP1
FASTENERS PENETRATING

WOOD DECK 3/4" MIN)
FULL DYNACLAD ULTRA HT WIND
& WATER SEAL UNDERLAYMENT
TO EXTEND UP WALL 8" MIN.

PLYWOOD SHEATHING (MIN.
5/8" THICK)

2" MIN.

1 1/2" MIN

3"



HYDROSTATIC APRON W/ COPING

Detail:

DL20 06-04-WH

• PROVEN • DEPENDABLE • SUSTAINABLE •

Issue/Rev Date:

Scale:

METAL ENVELOPE SYSTEMS SINCE 1988

01/17

3"=1'-0"

WWW.DMIMETALS.COM