

FLASHING LAP NOTE

LAP RAKE EDGE AND FASCIA 2" MINIMUM WITH 1 ROW OF BUTYL SEALANT.

DYNACLAD ULTRA HT WIND & WATER SEAL UNDERLAYMENT TO EXTEND DOWN RAKE EDGE 4" MIN. AND OVER THE TOP OF THE FASCIA WRAP AND NAILED INTO FASCIA 6" O.C.

#10-13 GP PANCAKE HEAD FASTENER 12" O.C.

1/4" WOOD FILLER

FIELD FOLD SIDE OF PANEL

(RA) - RAKE EDGE

#10-13 GP PANCAKE HEAD FASTENER 12" O.C.

(FW) - FASCIA WRAP

WOOD BLOCKING

DMI DL20 EXPANSION PANEL CLIP 30" O.C. MAX. (FASTENED WITH 2 #14-13 X 1 1/2" DP1 FASTENERS PENETRATING WOOD DECK 3/4" MIN) DL20 DMI PANEL SYSTEM

DYNACLAD AP SYNTHETIC UNDERLAYMENT

PLYWOOD SHEATHING (MIN. 5/8" THICK)

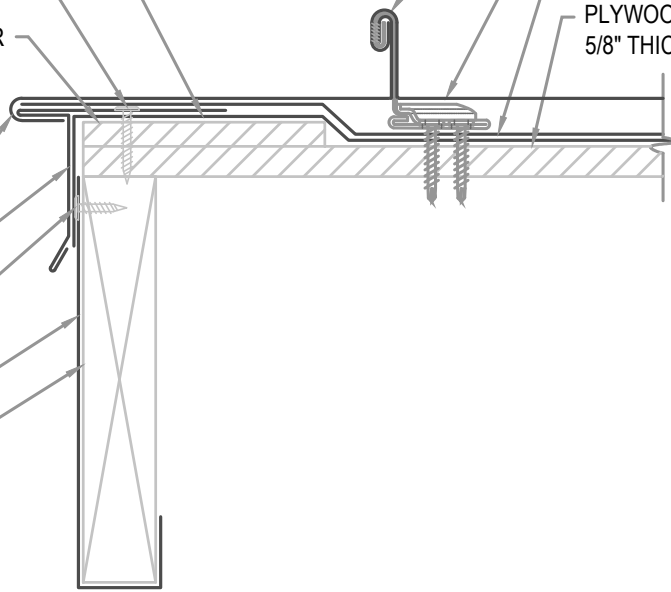

ARCHITECTURAL RAKE EDGE

• PROVEN • DEPENDABLE • SUSTAINABLE •
METAL ENVELOPE SYSTEMS SINCE 1988

WWW.DMIMETALS.COM

Detail:

DL20 04-00-W

Issue/Rev Date:

01/17

Scale:

3"=1'-0"