

**FLASHING LAP NOTE**

LAP RAKE EDGE AND FASCIA 2" MINIMUM WITH 1 ROW OF BUTYL SEALANT.

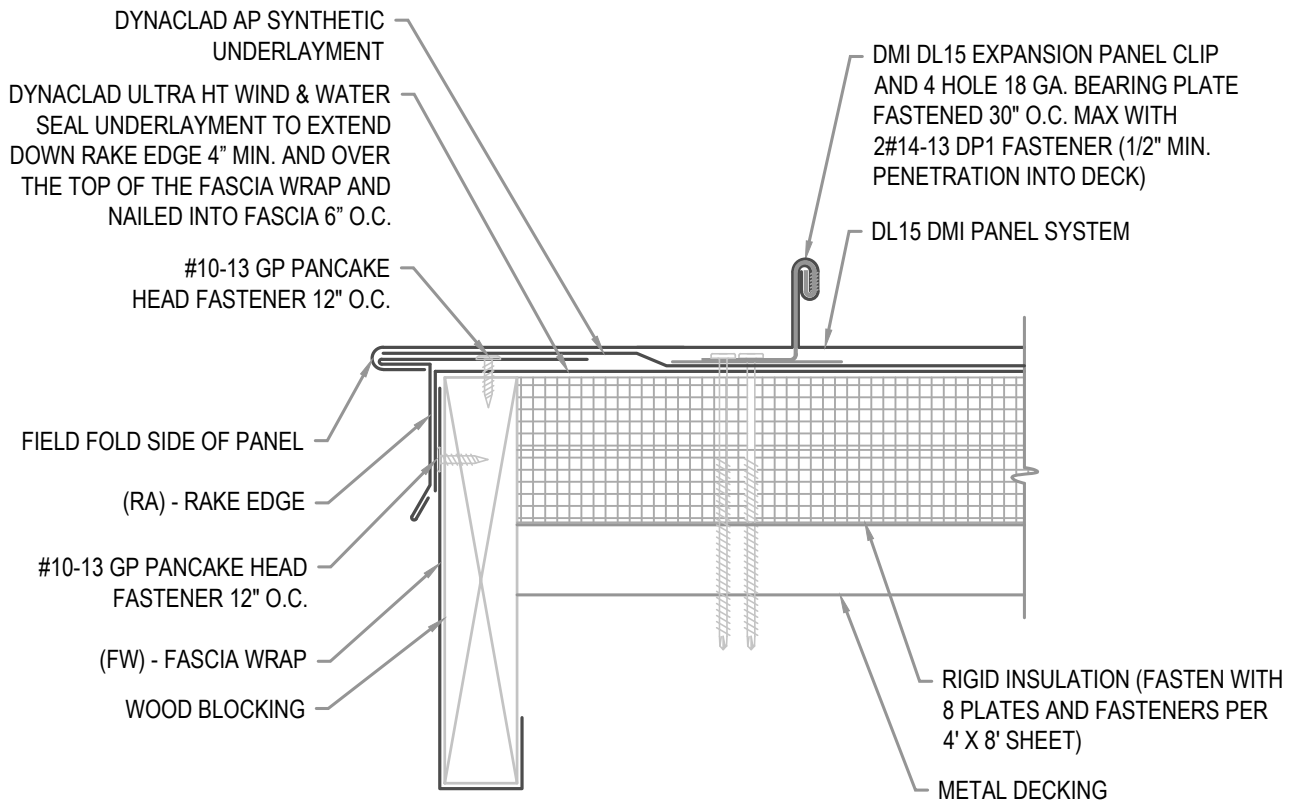

**ARCHITECTURAL RAKE EDGE**

**• PROVEN • DEPENDABLE • SUSTAINABLE •**  
**METAL ENVELOPE SYSTEMS SINCE 1988**

WWW.DMIMETALS.COM

Detail:

**DL15 04-00-IA**

Issue/Rev Date:

**01/17**

Scale:

**3"=1'-0"**